

## > DÖNER FLANŞLI METAL KOMPANSATÖR METAL EXPANSION JOINT

### UEJ-0901



Basınç Sınıfı : PN16 / PN25  
Körük : Paslanmaz çelik  
Flanş : Karbon çelik  
Genleşme : 30 mm / 60 mm  
Flanşlı

Pressure Rating : PN16 / PN25  
Bellow : Stainless steel  
Flange : Carbon steel  
Expansion : 30 mm / 60 mm  
Flanged

#### PRODUCT SIZE

PRODUCT	SIZE
UEJ-0901X025	DN 25
UEJ-0901X032	DN 32
UEJ-0901X040	DN 40
UEJ-0901X050	DN 50
UEJ-0901X065	DN 65
UEJ-0901X080	DN 80
UEJ-0901X100	DN 100
UEJ-0901X125	DN 125
UEJ-0901X150	DN 150
UEJ-0901X200	DN 200
UEJ-0901X250	DN 250

#### CERTIFICATIONS

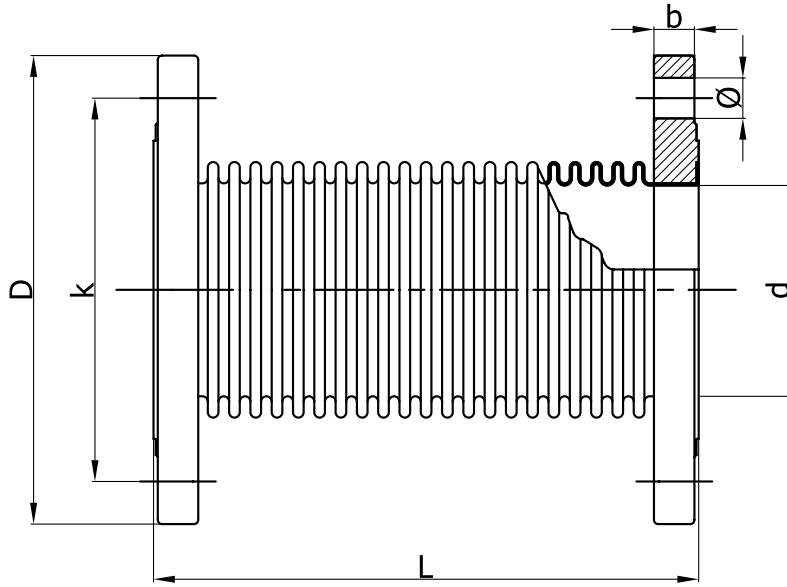

#### MALZEME / MATERIALS

Körük / Bellow : Paslanmaz çelik / Stainless steel  
Layner / Liner : Paslanmaz çelik / Stainless steel  
Flanş / Flange : Karbon çelik / Carbon steel

#### GENEL ÖZELLİKLER / GENERAL PROPERTIES

Standart No : TS 10880  
Basınç Sınıfı / Pressure Rating : PN16 / PN25  
Maksimum Çalışma Sıcaklığı / Maximum Working Temp. : 420 °C

DN	L (30mm)	L (45mm)	L (60mm)	D	d	k	b	n	Ø
25	110			115	43	85	18	4	14
32	110			140	43	100	18	4	18
40	120	150		150	49	110	18	4	18
50	120	150		165	61	125	18	4	18
65	120	150	180	185	77	145	18	4	18
80	120	150	180	200	89	160	20	8	18
100	120	150	185	220	115	180	20	8	18
125	125	155	190	250	140	210	22	8	18
150	130	155	200	285	169	240	22	8	22
200	150	190	230	340	220	295	24	12	22
250	165	205	245	405	274	355	26	12	26